

LP8 Data Sheet

Functions

Lifting capacity : 300 kg
Lifting speed : 50 mm/sec
Lifting height : 0-3000 mm

Operation

Electric : Operating panel
Emergency stop : Electronic
Emergency lowering : Mechanical
Safety lists : Mechanical/electric safety lists

Weight

Own weight : 650 kg

Materials

Materials : Aluminium
Materials : Powder coated/galvanized steel
Colour : Grey RAL 7037

Item No.	A	B
30900010	2275 mm	1079 mm
30900012	2475 mm	1279 mm
30900014	2675 mm	1479 mm
30900016	2875 mm	1679 mm
30900020	3433 mm	2079 mm
30900023	3883 mm	2379 mm
30900026	4334 mm	2679 mm
30900030	4933 mm	3059 mm

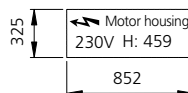
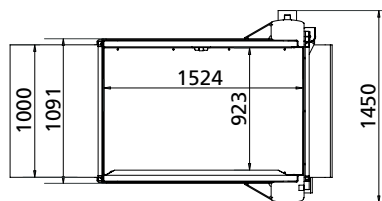
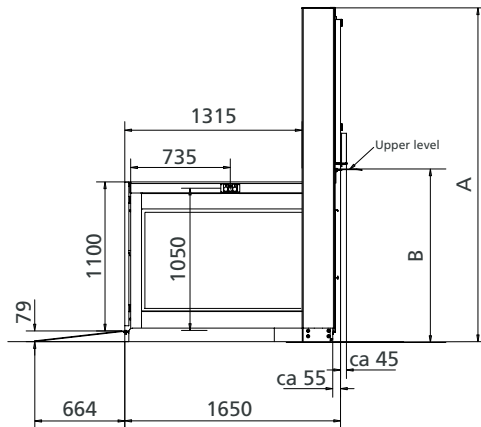

Electrical parts

Door motor : 24 V DC
Frequency : 50 Hz
Hydraulic motor : 230 V, 1,1 kW, 1400 r/min.
Voltage : 230 V/10 A
Control current : 24 V AC
Heating cable cassette (accessories) : 220 W

Hydraulic unit

Working pressure : max. 86 bar
Oil : 7 l

Application

Indoor and outdoor temperature : -30°C - +50°C
(At temperatures below -10°C heating cable cassette is required)

Accessories/ miscellaneous

: Key switch on operating panels
: Battery operated emergency lowering
: Heating cable cassette (under -10°C)
: Remote control
: Glass on sides and doors

Marking

CE-marked according to ISO/DIS 9386-1 : Power-operated lifting platforms for persons with impaired mobility
EN 60601-1-2 : Medical electrical equipment
98/37/EF : Approximation of the laws on the safety of machines within the EU

Item number/model

309100xx : LP8
30906100-L : Automatic door, lower level, left
30906100-R : Automatic door, lower level, right
30906300-L : Automatic door, upper level, left
30906300-R : Automatic door, upper level, right

Classification

According to ISO 9999 : 18 30 06